

# Stereo Headphones

Operating Instructions  
使用説明書  
사용설명서



4-439-652-12(1)

XBA-20

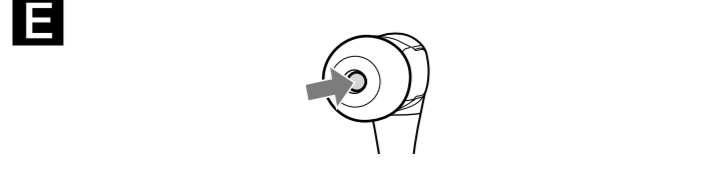
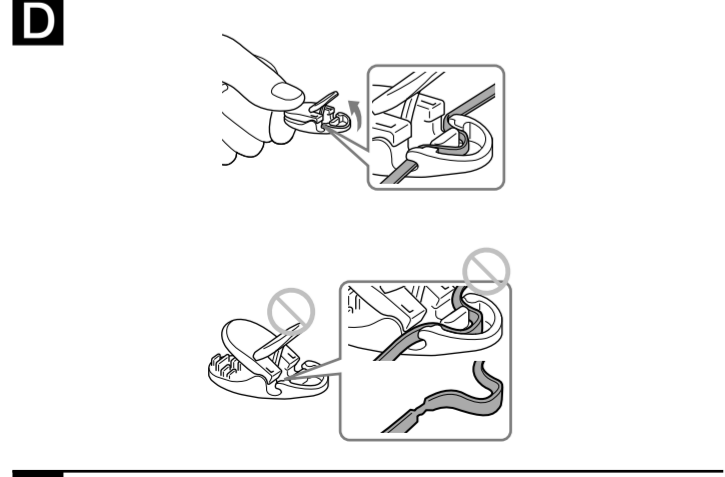
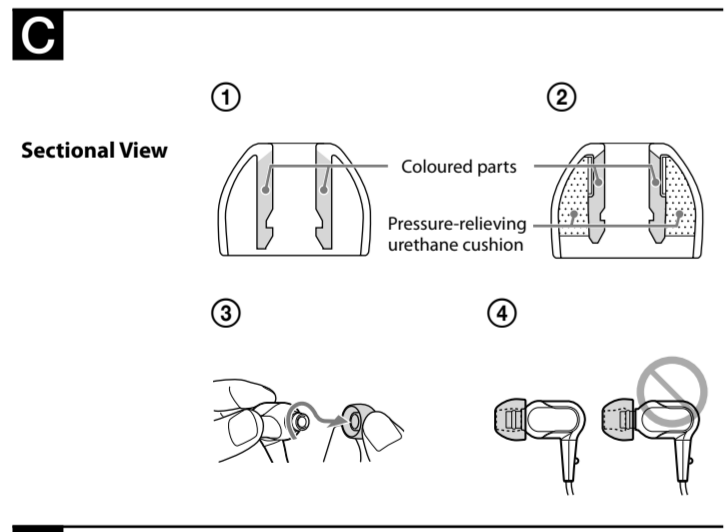
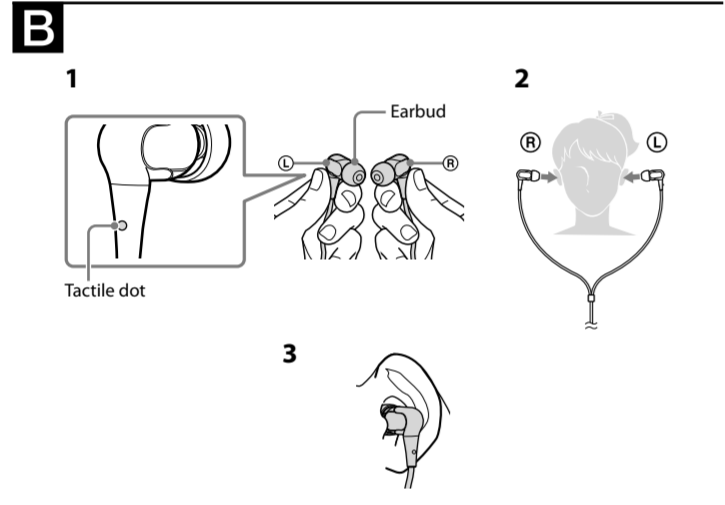
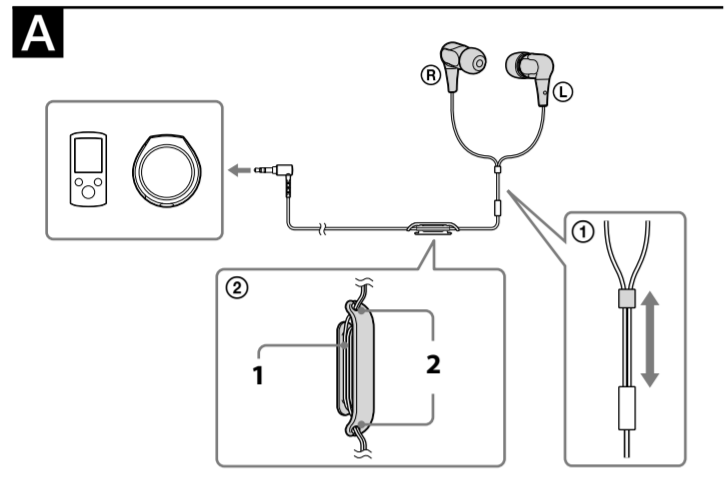

## English

### Stereo headphones

### Features

- **Dual Balanced Armature driver unit**  
Micro-size Balanced Armature driver unit (full-range + woofer) reproduces smooth and clear vocal sound.
- **High quality PCOCC cord**  
PCOCC cord to minimise sound transmission loss and reproduce a clear high quality sound.
- **Double Layered Housing**  
Magnesium inner housing holds the driver units rigidly for smooth sound response. Special ABS plastic outer housing prevents unwanted vibration for clear mid-high range.
- **Noise-Blocking design and various ear-bud sizes**  
Noise-Blocking design, with 10 sets of ear-buds to choose from, for optimum attenuation of ambient noise and minimum sound leakage.
- **Super-small body**  
Balanced Armature driver unit allows for a super small body, and ultimate wearing comfort.
- **Serrated cord**  
Serrated cord and cord slider for tangle-free use.

### How to use

#### Using the cord slider (see fig. A-①)

Move up and down to change the split position of the cord.

#### Using the supplied cord adjuster (see fig. A-②)

You can adjust the cord length by winding the cord on the cord adjuster. (The cord can be wound to the cord adjuster up to 50 cm. If you wind more, the cord comes off from the cord adjuster easily.)

##### 1 Wind the cord.

##### 2 Push cord into slot hole to secure in place.

#### Note

Do not wind the plug or split section of the cord, as it will strain the cord and may cause a wire break.

### Wearing the headphones (see fig. B)

#### 1 Determine right and left headphone and hold them as in the illustration.

There is a tactile dot on the unit marked L to distinguish the left side.

#### 2 Fit the headphones into your ears snugly, as in the illustration.

#### 3 Adjust the headphone to fit snugly in your ear.

### Installing the earbuds correctly (see fig. C)

If the earbuds do not fit your ears correctly, low-bass sound may not be heard. To enjoy better sound quality, change the earbuds to another size or type, or adjust the earbuds position to sit on your ears comfortably and fit your ears snugly. If the earbuds do not fit your ears, try another size or type. Confirm the size of the earbuds by checking the colour inside (see fig. C-① for hybrid silicone rubber earbuds and C-② for noise isolation earbuds).

When you change the earbuds, install them firmly on the headphones to prevent the earbud from detaching and remaining in your ear.

#### About hybrid silicone rubber earbuds (see fig. C-①)

##### Earbud sizes (inside colour)

	Small	Large
High	–	ML (Blue) LL (Purple)
	S (Orange)	M (Green) L (Light blue)
Low	SS (Red)	MS (Yellow) –

#### To clean the hybrid silicone rubber earbuds

Remove the earbuds from the headphones, and wash them with a mild detergent solution.

#### About noise isolation earbuds (see fig. C-②)

Supplied noise isolation earbuds provides a snug fit for effective attenuation of ambient noise.

##### Earbud sizes (inside colour)

Small	Large
S (Orange)	M (Green) L (Light blue)

#### Notes

- Prolonged use of the noise isolation earbuds may strain your ears due to their snug fit. If you have experience discomfort or pain in your ears, discontinue use.
- The pressure-relieving urethane cushion is extremely soft. Therefore, do not pinch or pull the urethane cushion. If the urethane cushion is broken or detached from the earbuds, it will not take its correct position and the earbuds will lose their noise isolation function.
- The pressure-relieving urethane cushion may deteriorate due to long-term storage or use. If the pressure-relieving power is lost and the urethane cushion becomes hard, the earbuds may lose their noise isolation function.
- Do not wash the noise isolation earbuds. Keep them dry, and avoid accumulation of water in the pressure-relieving urethane-cushions. Not doing so may cause early deterioration.

#### To detach an earbud (see fig. C-③)

While holding the headphone, twist the parts inside of the earbud and pull the earbud off.

#### Tip

If the earbud slips and cannot be detached, wrap it in a dry soft cloth.

#### To attach an earbud (see fig. C-④)

Push the parts inside of the earbud into the headphone until the projecting part of the headphone is fully covered.

### How to attach the clip to the cord (see fig. D)

#### 1 Hold the clip closed, and pull up the lever on the clip just a little.

#### 2 Put the cord into the groove under the lever.

#### Notes

- If you pull up the lever on the clip without holding the clip closed, or holding the clip closed but opening the lever too much, you cannot put the cord into the groove under the lever.
- Do not catch the cord on the projection of the clip or do not wedge it into the groove. It may damage the wires of the cord.
- Do not move the clip position with the cord attached. It may damage the wires of the cord.

### Removing the headphones

After use, remove the headphones slowly.

#### Note

Headphones are designed to fit closely in your ears. If the headphones are pressed hard while in use or taken off too quickly, they may cause injury. Wearing headphones may produce a diaphragm click sound. This is not a malfunction.

## Specifications

<b>Type:</b>	Closed, Dual Balanced Armature
<b>Driver unit:</b>	Dual Balanced Armature
<b>Power handling capacity:</b>	100 mW (IEC*)
<b>Impedance:</b>	12 Ω at 1 kHz
<b>Sensitivity:</b>	108 dB**
<b>Frequency response:</b>	4 Hz – 25,000 Hz
<b>Cord:</b>	1.2 m cord, using PCOCC (Y-type)
<b>Plug:</b>	Gold-plated L-shaped stereo mini plug
<b>Mass:</b>	Approx. 6 g (without cord)

### Supplied accessories

Hybrid silicone rubber earbuds: SS (red) (2), S (orange) (2), MS (yellow) (2), M (green) (attached to the unit at the factory) (2), ML (blue) (2), L (light blue) (2), LL (purple) (2)  
Noise isolation earbuds: S (orange) (2), M (green) (2), L (light blue) (2)  
Cord adjuster (winds cord up to 50 cm) (1)  
Carrying case (1)  
Operating Instructions (1)

\* IEC = International Electrotechnical Commission

\*\* 150 mV input

Design and specifications are subject to change without notice.

## Precautions

- Please keep your headphones clean at all times especially inside the rubber earbud. (see fig. E)  
If any dust or ear wax is inside the earbud, you may experience some listening difficulties.
- Listening with headphones at high volume may affect your hearing. For traffic safety, do not use while driving or cycling.
- Handle the driver units carefully.
- Do not put weight or pressure on the headphones as it may cause the headphones to deform during long storage.
- The earbuds may deteriorate due to long-term storage or use.
- Install the earbuds firmly onto the headphones. If an earbud accidentally detaches and is left in your ear, it may cause injury.
- Store the earbuds where children cannot reach in order to prevent from accidental ingestion or choking.
- Do not leave the stereo headphones in a location subject to direct sunlight, heat or moisture.

### Note on static electricity

In particularly dry air conditions, mild tingling may be felt on your ears. This is a result of static electricity accumulated in the body, and not a malfunction of the headphones. The effect can be minimized by wearing clothes made from natural materials.

Optional replacement earbuds can be ordered from your nearest Sony dealer.

