

Radio Cassette-Corder

Operating instructions

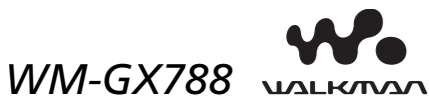

©2003 Sony Corporation Printed in China

<http://www.sony.net/>

"WALKMAN" is a registered trademark of Sony Corporation to represent Headphone Stereo products.

WALKMAN is a trademark of Sony Corporation.

The validity of the CE marking is restricted to only those countries where it is legally enforced, mainly in the countries EEA (European Economic Area).

WARNING

To prevent fire or shock hazard, do not expose the unit to rain or moisture.

Do not install the appliance in a confined space, such as a bookcase or built-in cabinet.

For customers in the United States Owner's Record

The model number is located on the front and the serial number is located inside the cassette holder. Record these numbers in the space provided below. Refer to them whenever you call upon your Sony dealer regarding this product.

Model No. WM-GX788

Serial No. _____

Product registration

Please register this product on line at www.sony.com/productregistration.
<<http://www.sony.com/productregistration>>

Proper registration will enable us to send you periodic mailings about new products, services, and other important announcements. Registering your product will also allow us to contact you in the unlikely event that the product needs adjustment or modification. Thank you.

INFORMATION

This equipment has been tested and found to comply with the limits for a Class B digital device, pursuant to Part 15 of the FCC Rules. These limits are designed to provide reasonable protection against harmful interference in a residential installation. This equipment generates, uses, and can radiate radio frequency energy and, if not installed and used in accordance with the instructions, may cause harmful interference to radio communications. However, there is no guarantee that interference will not occur in a particular installation. If this equipment does cause harmful interference to radio or television reception, which can be determined by turning the equipment off and on, the user is encouraged to try to correct the interference by one or more of the following measures:

- Reorient or relocate the receiving antenna.
 - Increase the separation between the equipment and receiver.
 - Connect the equipment into an outlet on a circuit different from that to which the receiver is connected.
 - Consult the dealer or an experienced radio/TV technician for help.
- This device complies with Part 15 of the FCC Rules. Operation is subject to the following two conditions:
- (1) This device may not cause harmful interference, and
 - (2) this device must accept any interference received, including interference that may cause undesired operation.

You are cautioned that any changes or modifications not expressly approved in this manual could void your authority to operate this equipment.

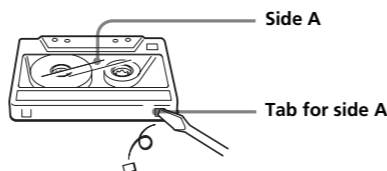
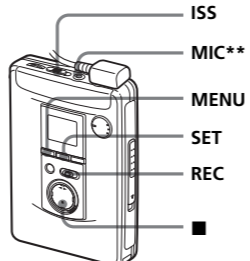
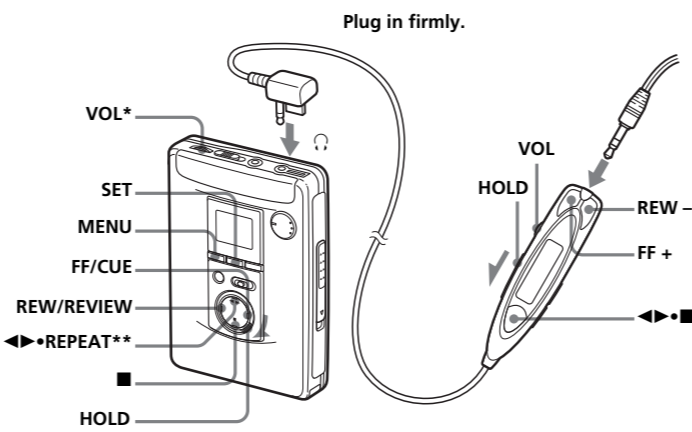
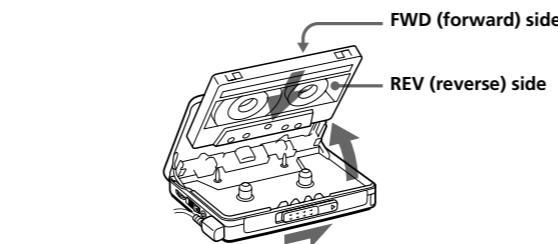
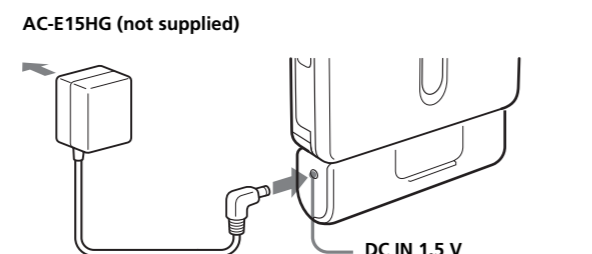
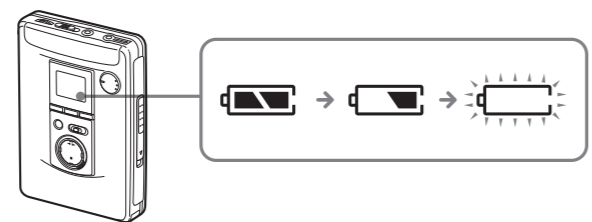
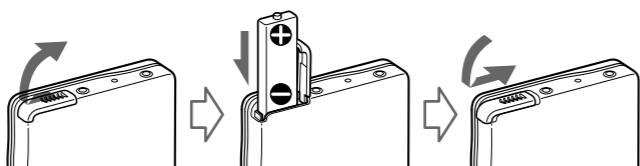
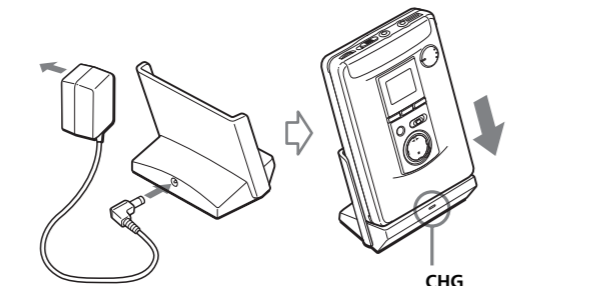
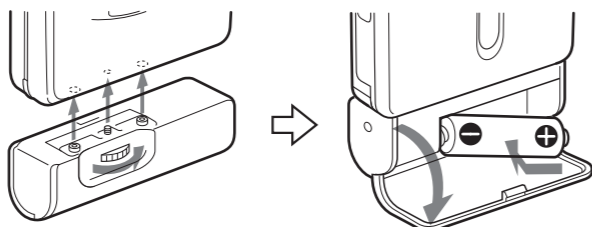

When to replace/charge the battery

Replace or charge the battery when " " flashes in the display.

Battery life* (Approx. hours)

Sony alkaline LR6 (SG)**

Tape playback	44
Radio reception	56
MIC recording	15
Radio recording	12

Rechargeable battery NH-14WM (A)

Tape playback	26
Radio reception	34
MIC recording	9
Radio recording	7

Sony alkaline LR6 (SG)** and Rechargeable NH-14WM (A)

Tape playback	70
Radio reception	90
MIC recording	24
Radio recording	19

* Measured value by the standard of JEITA (Japan Electronics and Information Technology Industries Association). (Using a Sony HF series cassette tape)

** When using a Sony LR6(SG) "STAMINA" alkaline dry battery (produced in Japan).

Notes

- The battery life may be shorter depending on the operating condition, the surrounding temperature and battery type.
- The AVLS setting (see "Using the Menu") will be cancelled when you replace the battery.

House Current

You must purchase an AC power adaptor AC-E15HG to operate this unit using house current. Remove the rechargeable battery if inserted. Attach the battery case and connect the AC power adaptor AC-E15HG (not supplied) to the DC IN 1.5 V jack of the battery case and to the wall outlet. Do not use any other AC power adaptor. Specifications for AC-E15HG vary for each area. Check your local voltage and the polarity of the plug before purchasing.

Note

- Do not use the unit while charging. Remove the unit from the charging stand when using it.
- If you operate the unit while charging, the battery will not be charged.
- If you operate the unit while charging, it may cause malfunction.
- Do not place the unit on the charging stand without the rechargeable battery. Otherwise, it may cause malfunction.

Note
Tapes recorded with setting to "2x" cannot be played properly on a cassette player/tape recorder without this function.

- To prevent fire, do not cover the ventilation of the apparatus with newspapers, table-cloths, curtains, etc. And don't place lighted candles on the apparatus.
- To prevent fire or shock hazard, do not place objects filled with liquids, such as vases, on the apparatus.
- Certain countries may regulate disposal of the battery used to power this product. Please consult with your local authority.

Preparations

Prepare a dry battery (not supplied) or the rechargeable battery (supplied).

Dry Battery

Attach the supplied battery case, and then insert one R6 (size AA) battery with correct polarity.

Note

For maximum performance we recommend that you use a Sony alkaline battery.

Rechargeable Battery

Charge the rechargeable battery before using it for the first time.

- 1 Insert the supplied rechargeable battery NH-14WM (A) into the rechargeable battery compartment with correct polarity.
- 2 Connect the supplied AC power adaptor to the charging stand, plug in the AC power adaptor to the house current (mains). If the plug does not fit to your mains, attach the supplied AC plug adaptor (Saudi Arabian model only).
- 3 Place the main unit on the charging stand. The CHG lamp will light up. Full charging takes about 6 hours. The CHG lamp will go off when the battery is fully charged.

- * There is a tactile dot beside VOL on the main unit to show the direction to turn up the volume.
- ** The button or jack has a tactile dot.

Playing a Tape

- 1 Insert a cassette and if the HOLD function is on, slide the HOLD switch in the opposite direction of the arrow to unlock the controls.

- 2 Press MENU repeatedly to set " " (the cursor) in the display to REC/PB. Then press SET to select "2x" or none (normal speed) which is the same position as that used for recording. To playback commercially available music tape, etc., select normal (no indication).

- 3 Press ◀▶•REPEAT on the main unit and adjust the volume with VOL. (On the remote control, press ◀▶(play)•■(stop).)

When adjusting the volume on the remote control

Set the VOL control on the main unit to around 6.

When adjusting the volume on the main unit

Set the VOL control on the remote control at maximum.

Operation on the remote control

To	Press
Switch playback to the other side	◀▶•■ for 2 seconds or more during playback
Stop playback	◀▶•■ once during playback

Operation on the main unit

To	Press
Switch playback to the other side	◀▶•REPEAT during playback
Stop playback	■ (stop)

Other tape operations

To	Press
Fast forward*	FF/CUE (FF + on the remote control) during stop
Rewind*	REW/REVIEW (REW - on the remote control) during stop
Search forward during playback (CUE)	Press and hold FF/CUE (FF + on the remote control) and release it at the point you want.
Search backward during playback (REVIEW)	Press and hold REW/REVIEW (REW - on the remote control) and release it at the point you want.

To	Press
Play the next track/succeeding 9 tracks from the beginning (AMS**)	FF/CUE (FF + on the remote control) once/repeatedly during playback
Play the current track/previous 8 tracks from the beginning (AMS**)	REW/REVIEW (REW - on the remote control) once/repeatedly during playback
Play the other side from the beginning (Skip Reverse function)	FF/CUE (FF + on the remote control) for 2 seconds or more during stop
Play the same side from the beginning (Rewind Auto Play function)	REW/REVIEW (REW - on the remote control) for 2 seconds or more during stop

* Press ◀▶•■ on the remote control during fast forward or rewind to start playback.

**Automatic Music Sensor

A-B Repeat

A-B Repeat plays back repeatedly any portion of the tape you specified. Specify by tagging the beginning (point A) and the end (point B) of the portion during playback.

On the main unit

- 1 Press ◀▶•REPEAT for 2 seconds or more during playback to tag point A. "A-" will flash in the display of the main unit.
- 2 Press ◀▶•REPEAT again to tag point B. "A-B" will flash and the tape will move rapidly to point A. Then "REP" appears in the display and the specified portion is played repeatedly.

On the remote control

- 1 Press ◀▶•■ twice quickly during playback to tag point A.
- 2 Press ◀▶•■ once more to tag point B. The tape will be rewound to point A. Then the specified portion is played repeatedly.

To stop the A-B Repeat playback

Press ◀▶•REPEAT on the main unit. On the remote control, press ◀▶•■.

To reset A-B Repeat

When you want to change a specific portion, stop the A-B Repeat playback and tag point A and point B again.

Notes

- You cannot specify a repeat portion that includes both sides of the tape.
- You cannot specify a repeat portion shorter than 2 seconds.
- After repeated operation, the actual portion that is played back may shift somewhat from the exact portion specified with the tags due to tape slack.

- 4 Slide REC. "REC" appears in the display and recording starts after about 2 seconds. If you have started recording from the FWD side, recording will switch to reverse side automatically at the end of the FWD side.

Recording

You can record radio programs from the built-in radio, or record with the supplied microphone. In either case, use a new or fully charged battery.

Note

If the record-protect tab is broken, you cannot record on that side.

- 1 Insert a normal (TYPE I) tape.

To record on both sides

Insert the cassette with the side to be first recorded on as the FWD (forward) side*.

* Make sure that "FWD" is displayed. If not, press and hold ■ until "REV" changes to "FWD".

To record on one side only

Insert the cassette with the side to be recorded on as the REV (reverse) side**.

**Make sure that "REV" is displayed. If not, press and hold ■ until "FWD" changes to "REV".

Note

When the cassette holder is opened, the direction of the tape will be automatically set to "FWD".

- 2 Press MENU repeatedly to set the cursor in the display to REC/PB. Then press SET to select "2x" or none (normal speed). Normal (no indication) (4.8cm/s): for optimum sound. Recommended for normal recordings.

- 2 Press MENU repeatedly to set the cursor in the display to REC/PB. Then press SET to select "2x" or none (normal speed). Normal (no indication) (4.8cm/s): for optimum sound. Recommended for normal recordings. 2x (2.4cm/s): for double recording time (for example, 120 minutes using both sides of a 60-minute cassette). Suitable for recording conferences, dictations, etc. Not recommended for recording music.

- 3 Select a recording source: **To record with the microphone**

Connect the supplied microphone to the MIC (PLUG IN POWER) jack. You can attach the microphone to your clothes.

To record from the radio

Tune in to the station you want to record (see "Listening to the Radio").

- 4 Slide REC.

"REC" appears in the display and recording starts after about 2 seconds.

If you have started recording from the FWD side, recording will switch to reverse side automatically at the end of the FWD side.

To stop recording

Press ■ (on the remote control, press ◀▶•■ to stop recording).

To reduce noise while recording AM programs

Set the ISS (Interference Suppress Switch) to the position that reduces noise the most.

To monitor the recording sound

You can monitor the recording sound through headphones/earphones. Adjust monitoring level using VOL.

Note

You may hear some noise in the monitor sound in the RV, MB, or GRV mode (see "Using the Menu"), but this does not affect recording.

Notes on recording

- The recording level is fixed.
- Sound emphasis (RV, MB, or GRV) and AVLS settings do not affect recording.
- Actual recording will start about 2 seconds (3 seconds when "2x" is selected for recording time) after you slide the REC button. Slide the REC button about 2 seconds (3 seconds when "2x" is selected for recording time) before the moment you want to start recording, or you will miss the beginning of your recording.
- When recording on both sides, recording will not be made for about 10 seconds while the tape is switching sides.
- Do not use a high-position (TYPE II) or metal (TYPE IV) tape. If you do, the sound may be distorted when you play back the tape, or the previous recording may not be erased completely.
- Do not connect or disconnect the headphones/earphones to/from □ while recording from the radio. The recording condition may change abruptly, or noise may be recorded.
- To avoid noise interference, do not place it near a lamp cord or a fluorescent lamp when recording with the microphone.
- If a howling effect occurs, turn down the volume.
- All other operation cannot be made while recording. For other operation, stop recording first.

To prevent a tape from being accidentally recorded over

Break off the tabs from side A and/or B. To reuse the tape for recording, cover the tab hole with adhesive tape.

